

Allgemeintoleranz ÖNORM EN 22768 mittel					Benennung E2-1a_V1.2_Torsteuerung
Projektion Maßstab					Zeichnungs-Nr. 00001
	1:2				Blatt 1

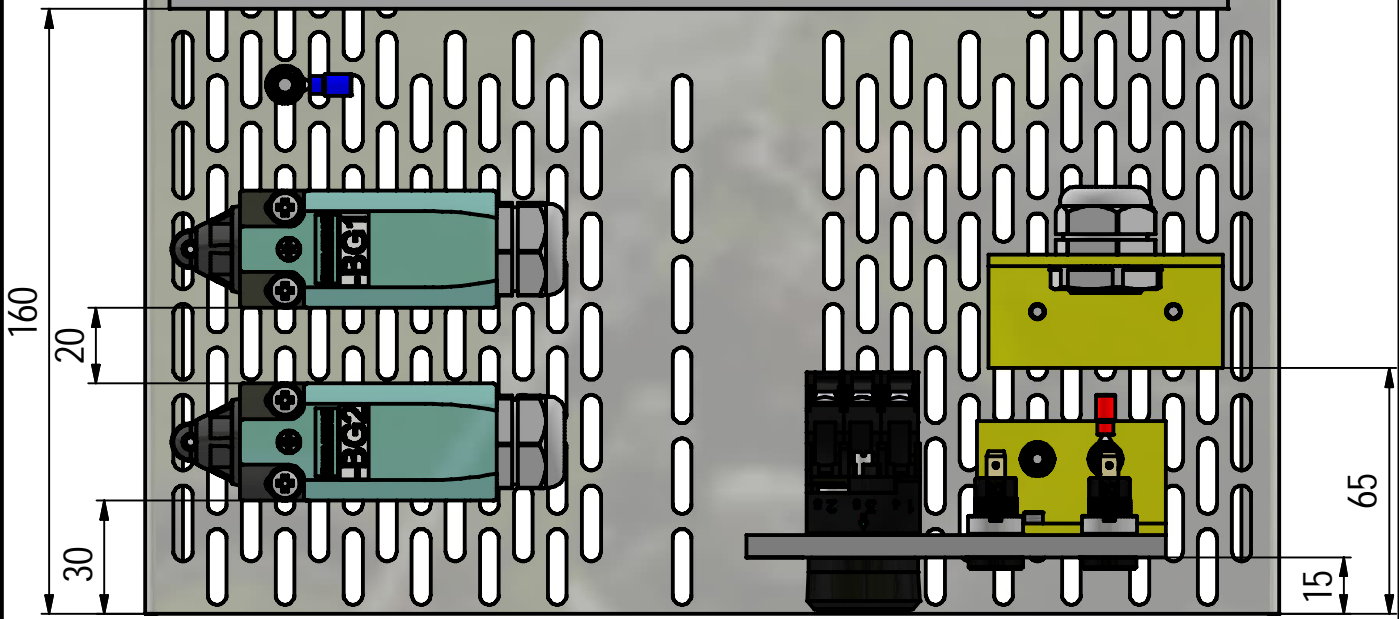

Toleranz $\pm 1\text{mm}$

Allgemeintoleranz ÖNORM EN 22768 mittel	
Projektion Maßstab	1:2

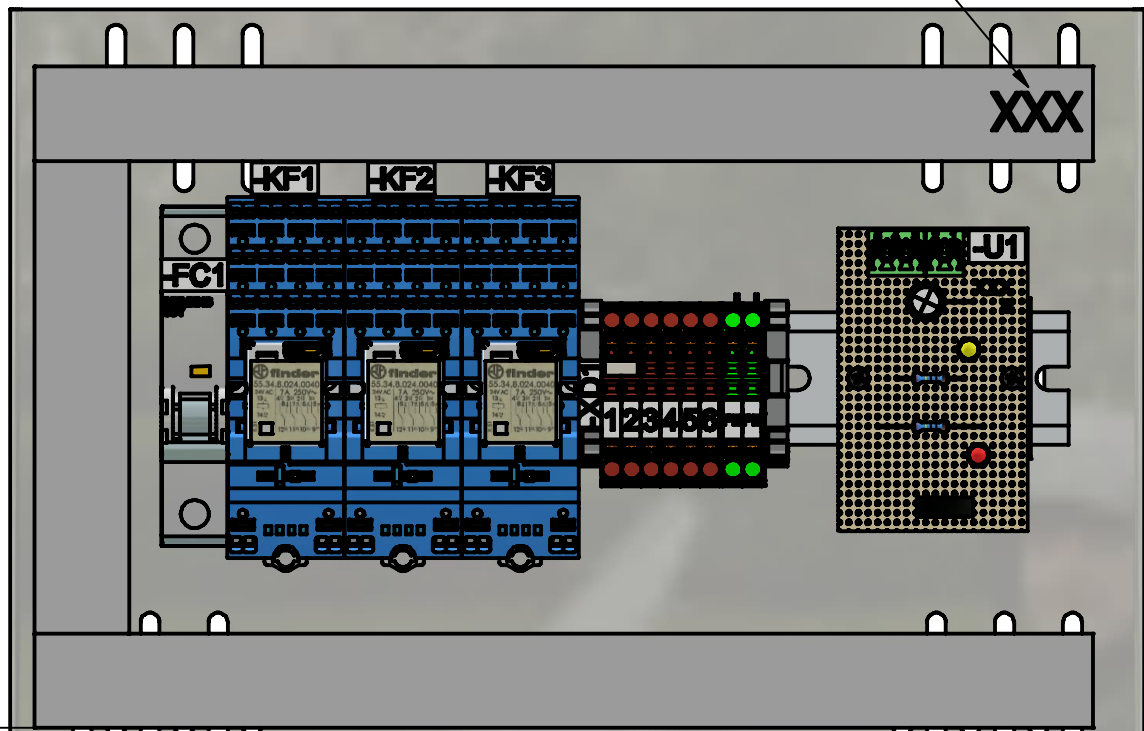
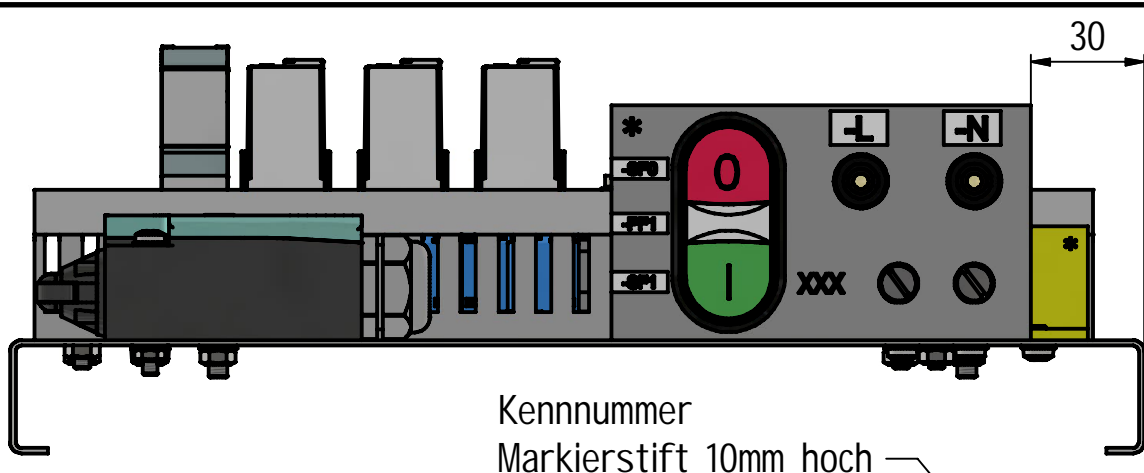

Benennung	E2-1b_v1.2_Torsteuerung		
Zeichnungs-Nr.	00002	Blatt	2

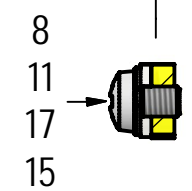
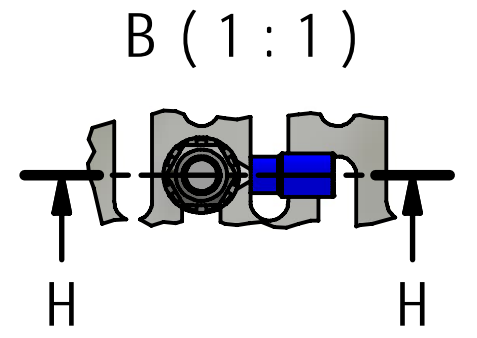
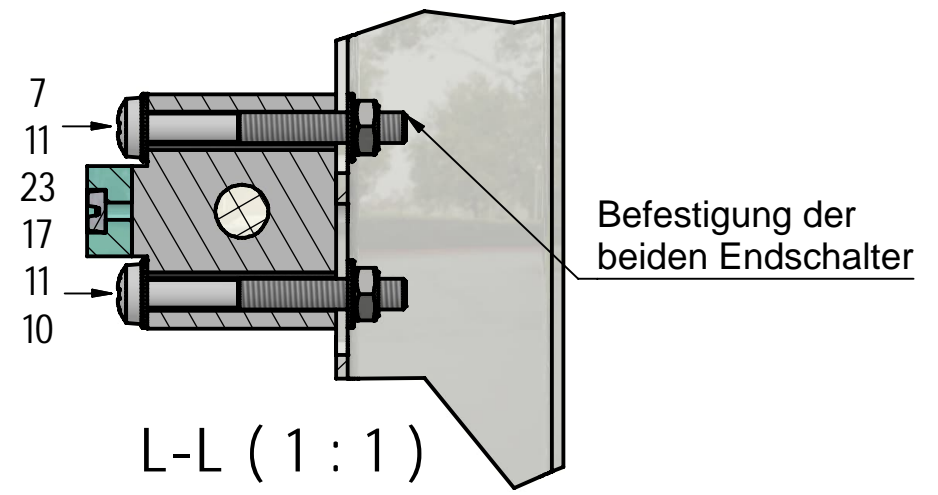
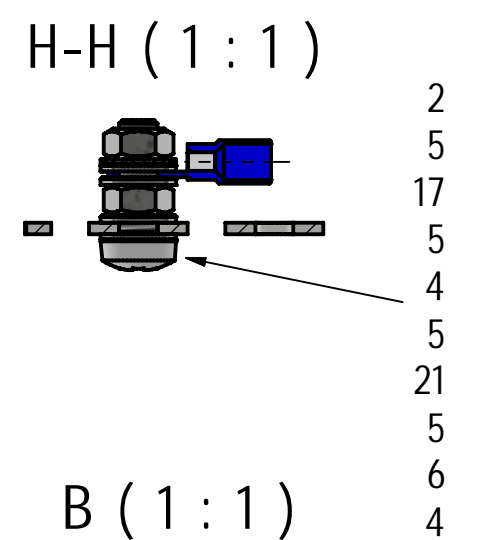
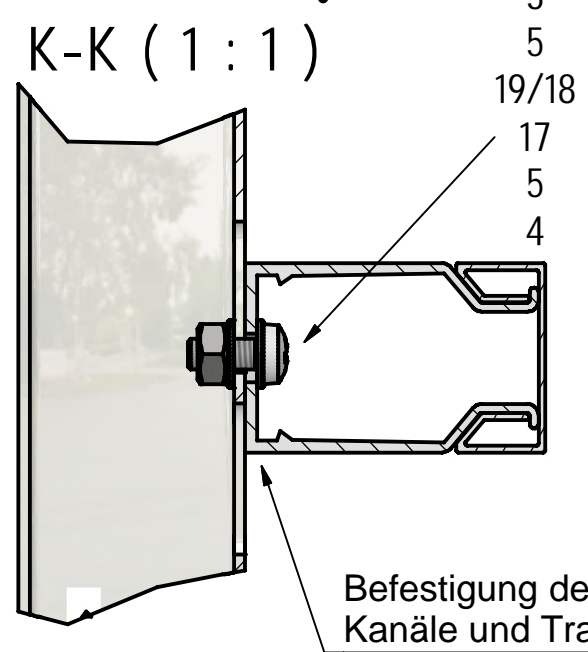
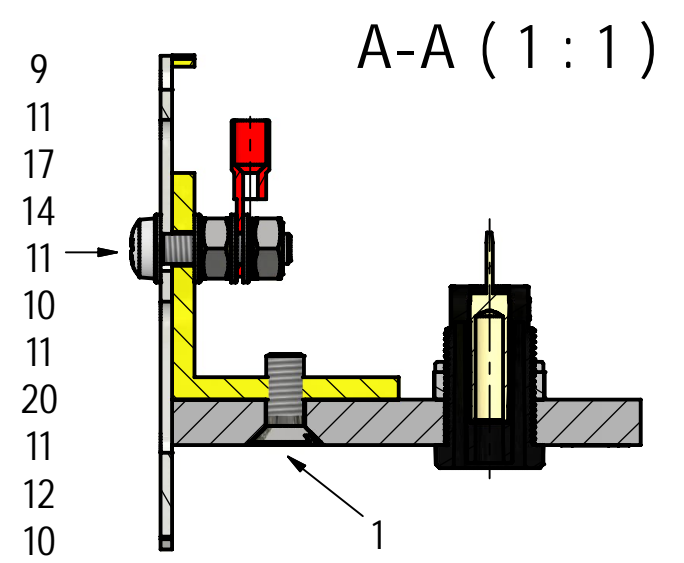
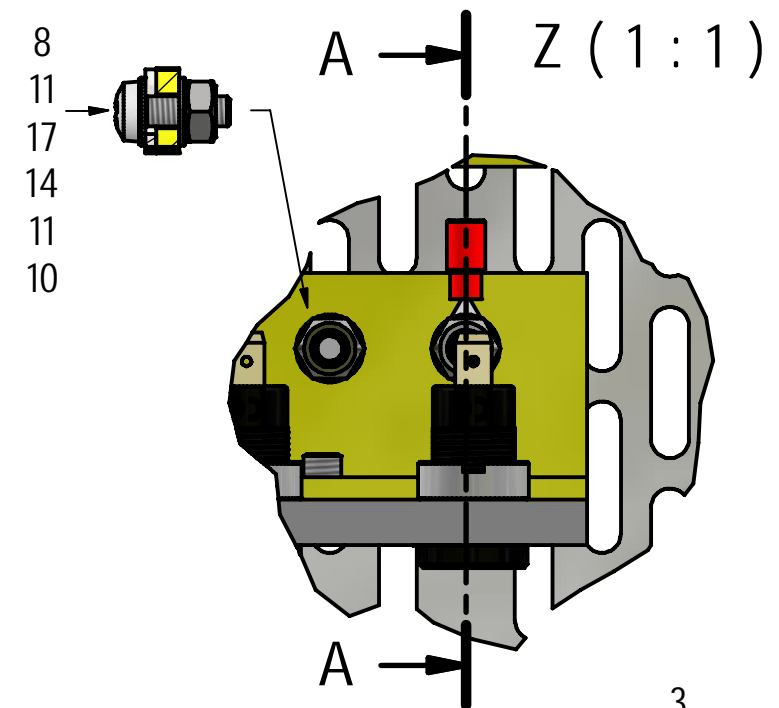
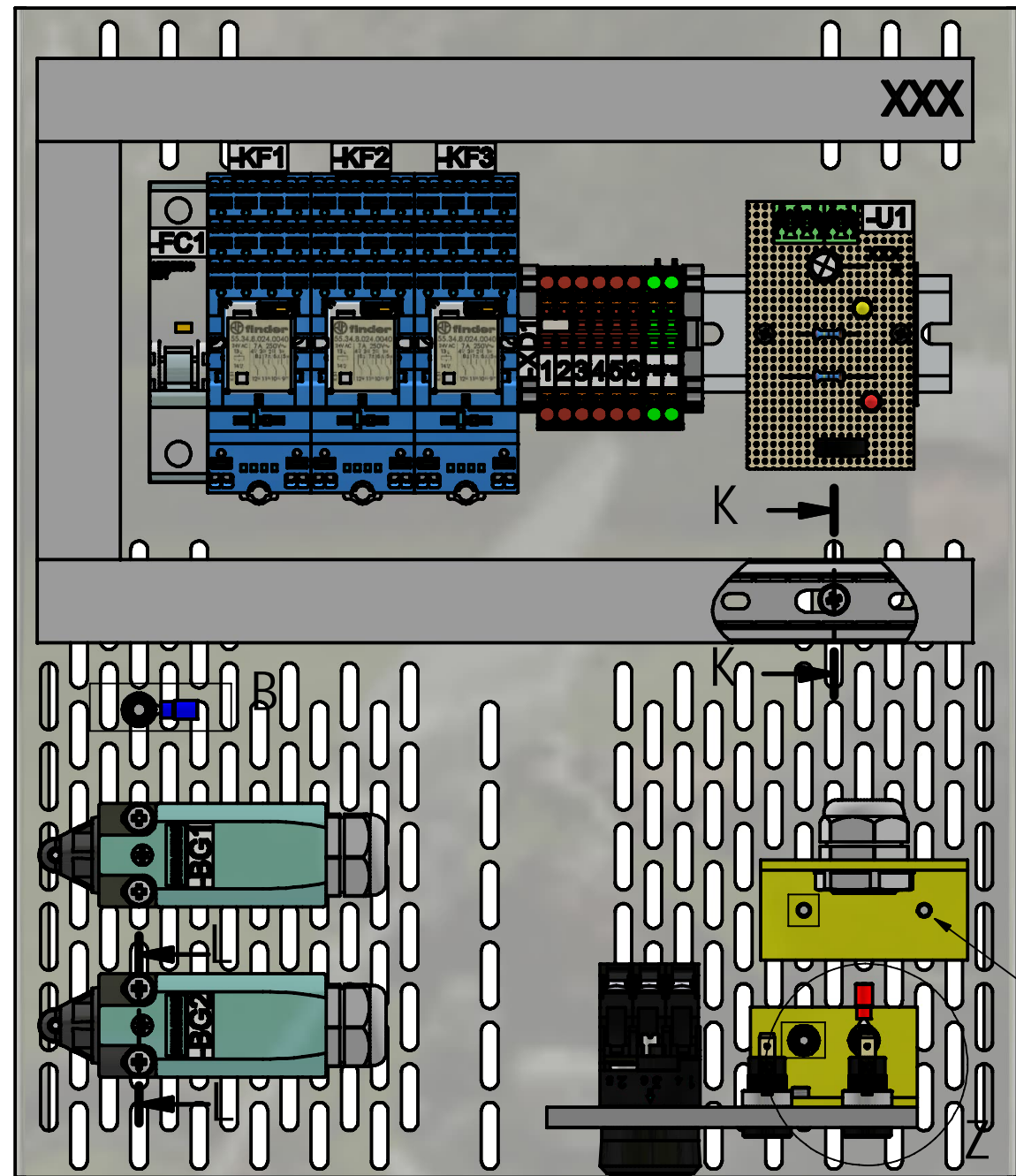
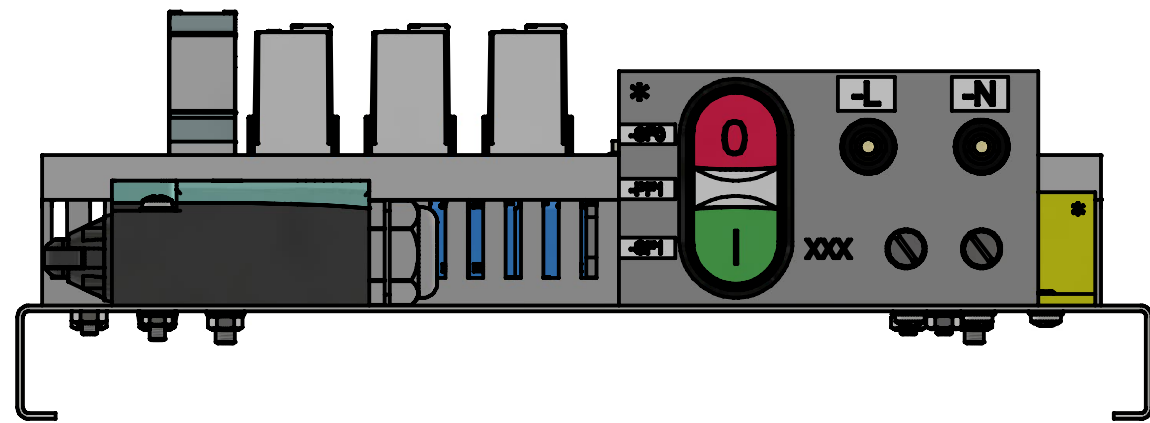

© Garfield 2023

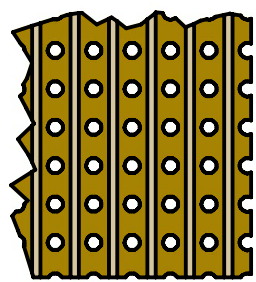
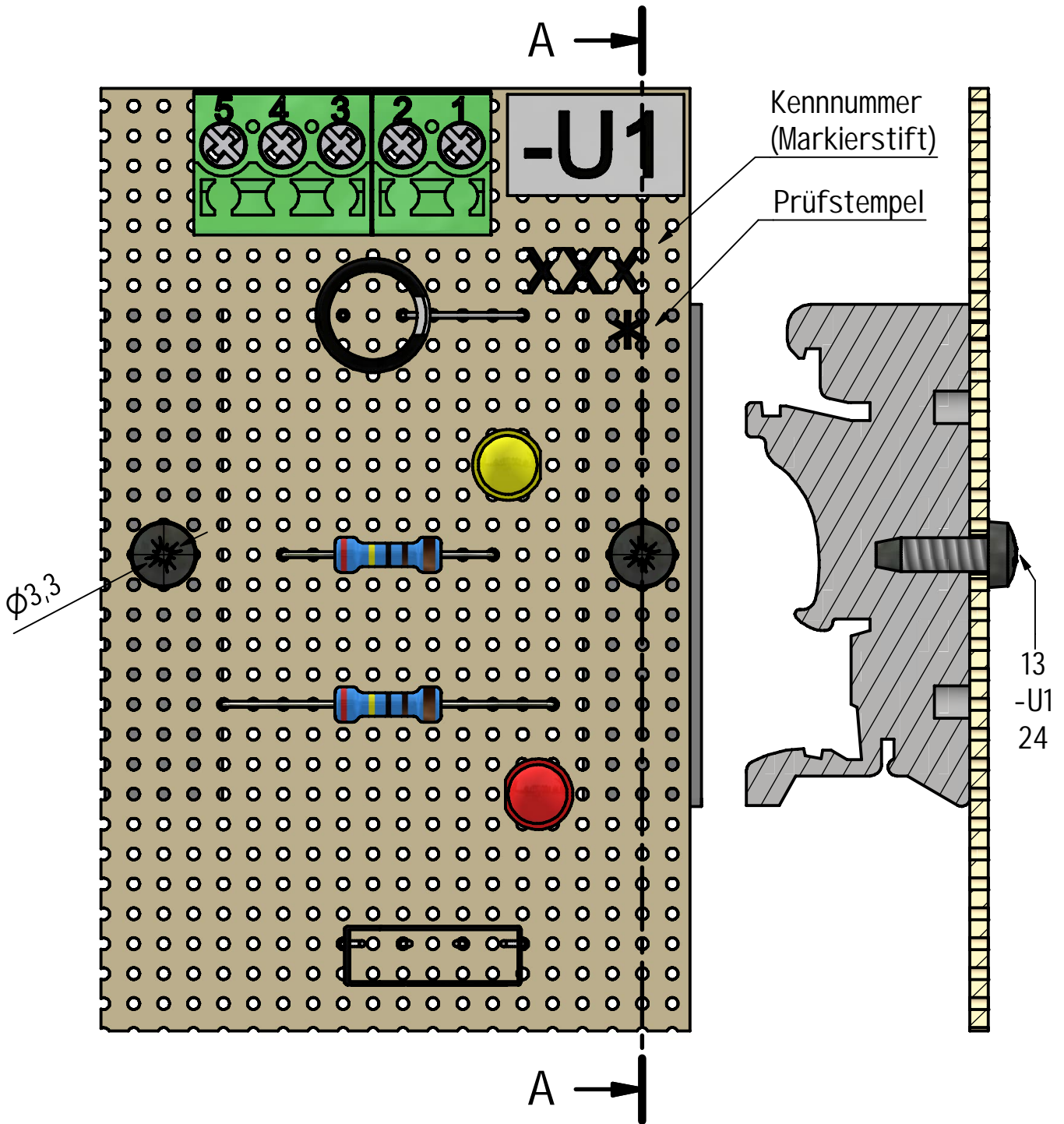

Allgemeintoleranz ÖNORM EN 22768 mittel	 WKO WIRTSCHAFTSKAMMER OBERÖSTERREICH DIE INDUSTRIE	Benennung E2-1c_v1.2_Torsteuerung	
Projektion Maßstab 1:2		Zeichnungs-Nr. 00003	Blatt 3



Rückseite

Allgmeintoleranz ÖNORM EN 22768 mittel	 WKO WIRTSCHAFTSKAMMER OBERÖSTERREICH DIE INDUSTRIE	Benennung	
		E2-1d_V1.2_Torsteuerung Platine	
Projektion 	Maßstab 2:1	Zeichnungs-Nr. 00004	Blatt 4

© Garfield 2023

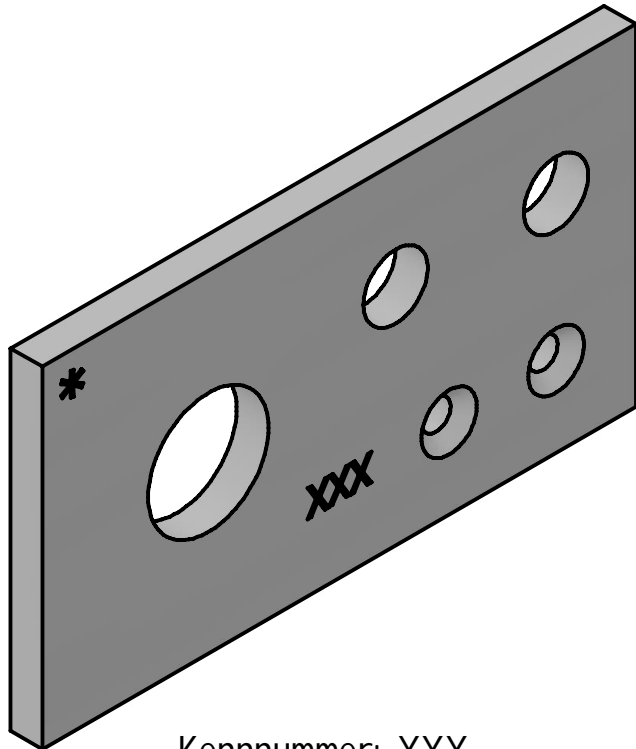

Kennnummer: XXX

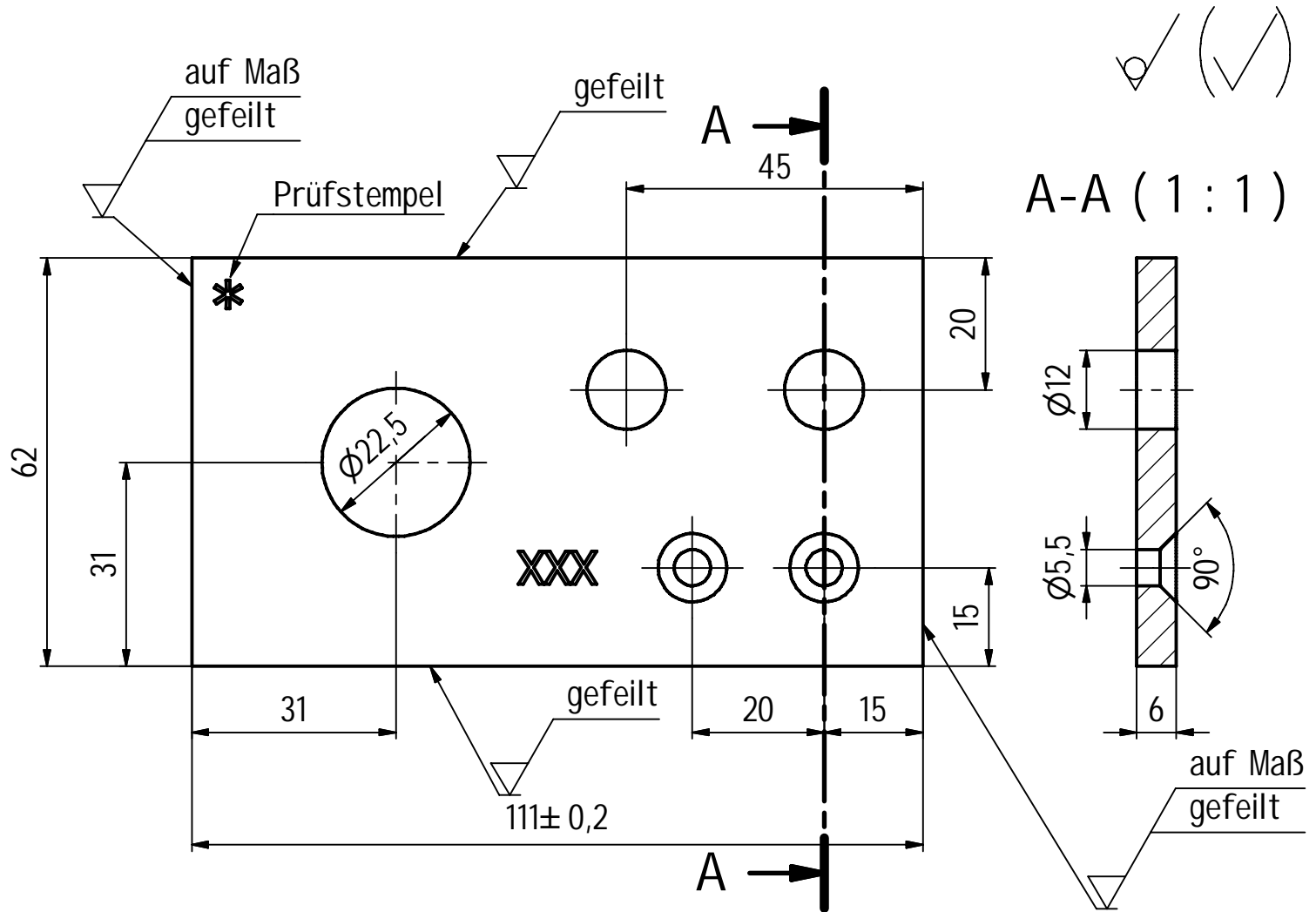

1	Platte	1	PVC 6mm Grau	62x112x6	0,049 kg
Pos.	Benennung	Anzahl	Werkstoff	Bemerkung	Gewicht
Allgemeintoleranz ÖNORM EN 22768 mittel					Benennung E2-1e_V1.2_Torsteuerung
Projektion	Maßstab				
	1:1				

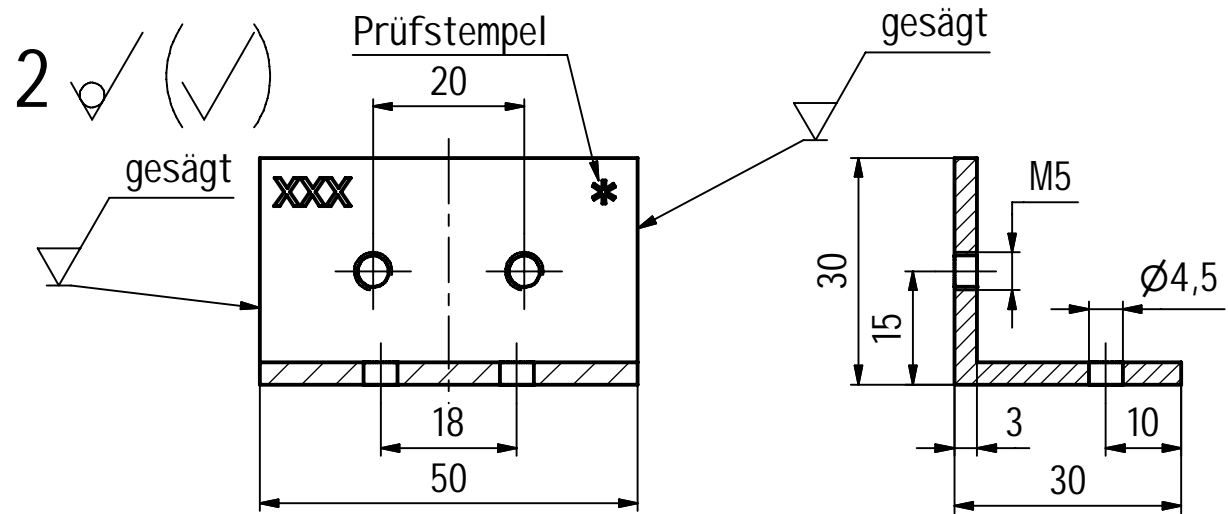
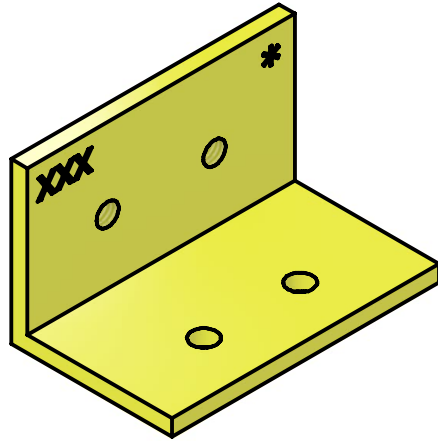

Kennnummer: XXX

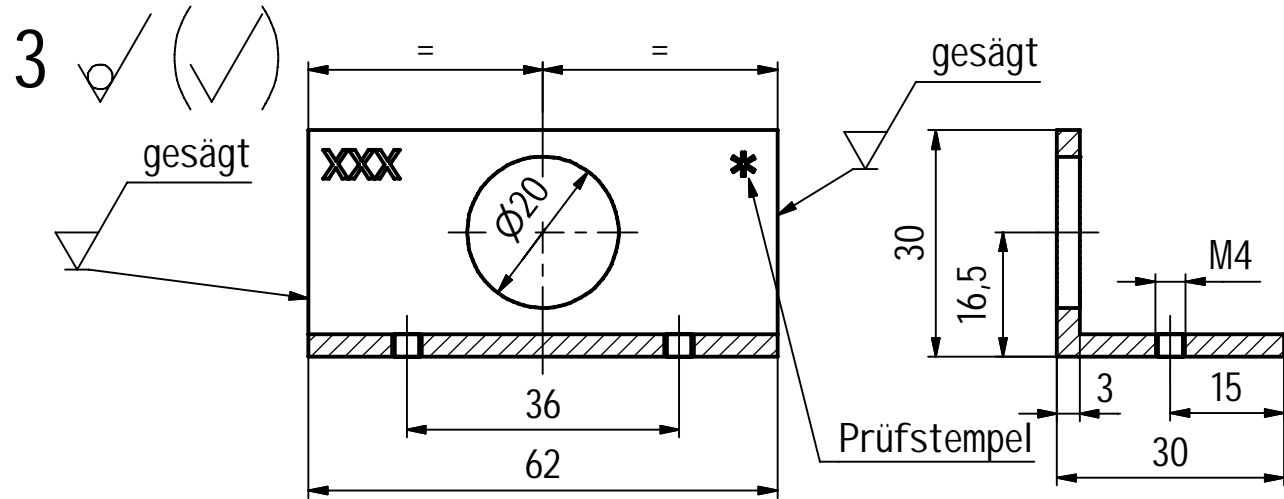
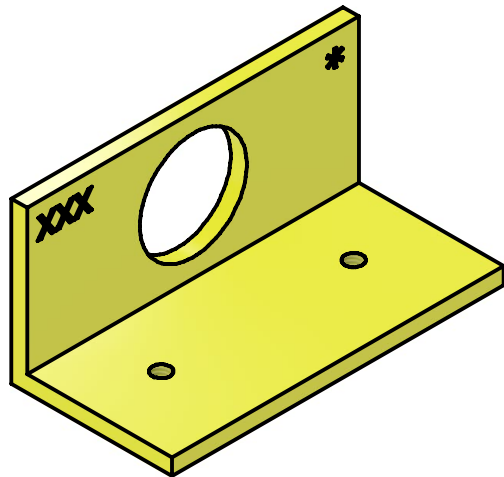

3	L-Profil	1	ALMGSI 0,5	30x30x62	0,026 kg
2	L-Profil	1	ALMGSI 0,5	30x30x50	0,023 kg
Pos.	Benennung	Anzahl	Werkstoff	Bemerkung	Gewicht

Allgemeintoleranz
ÖNORM EN 22768
mittel

Projektion
Maßstab
1:1



Benennung
E2-1f_V1.2_Torsteuerung

Zeichnungs-Nr. 00006 Blatt 6

Schnitte versetzt gezeichnet!

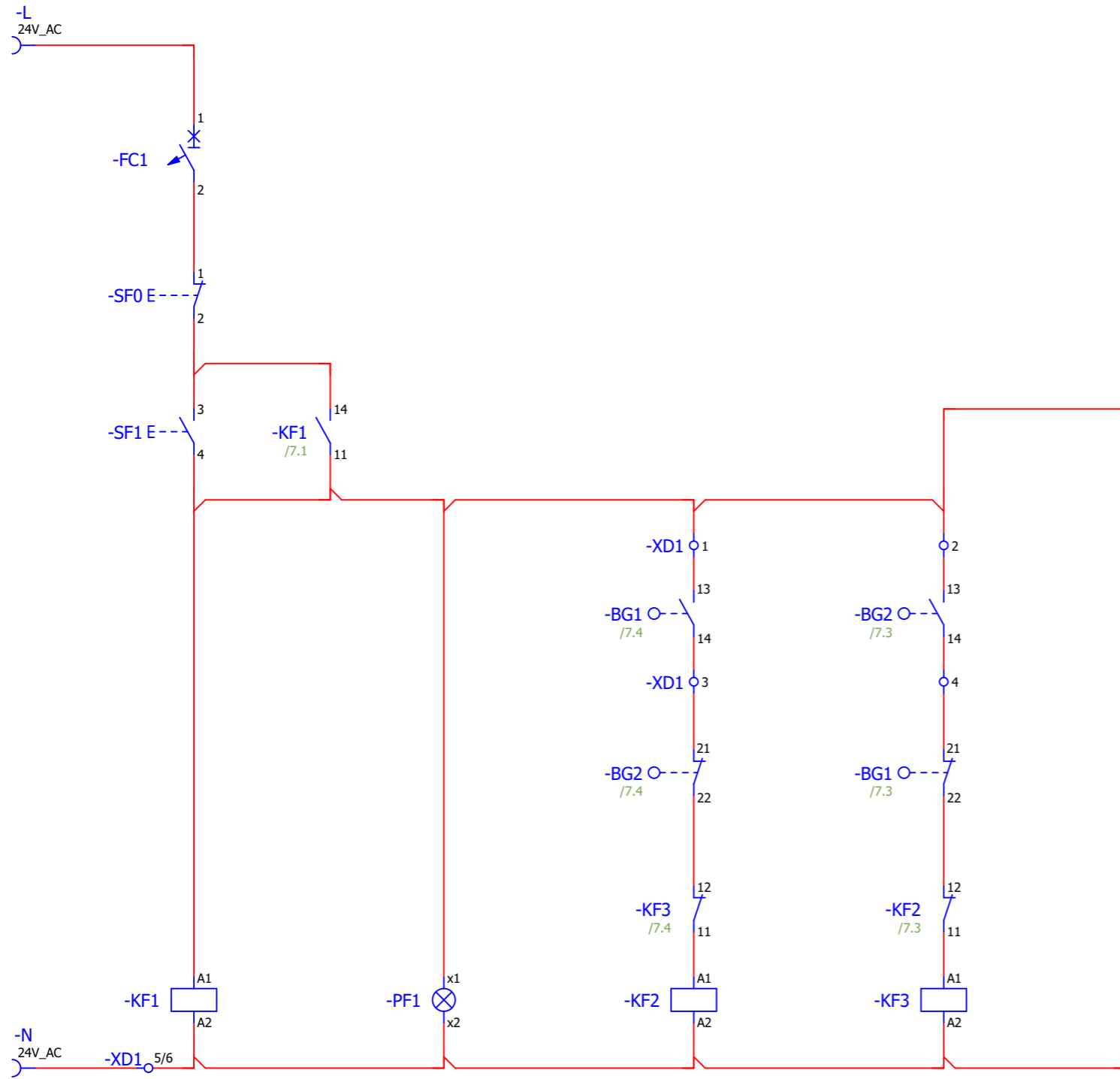

START

Torsteuerung EIN

TOR AUF

TOR ZU

14 --- 11 /7.2

12 --- 11 /7.4
24 --- 21 /7.6

12 --- 11 /7.3
24 --- 21 /7.6

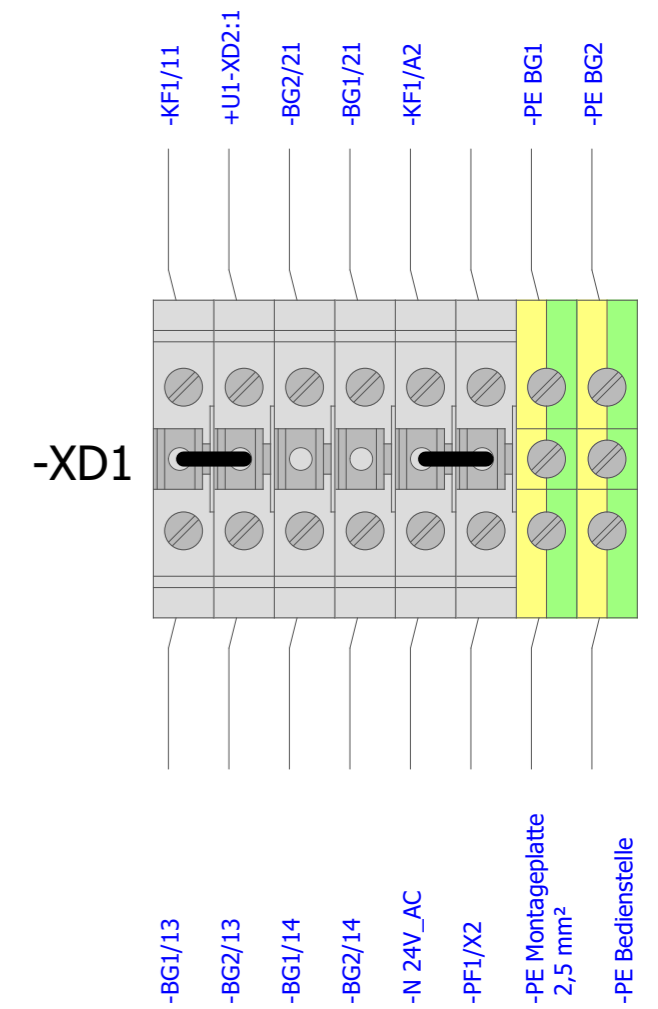
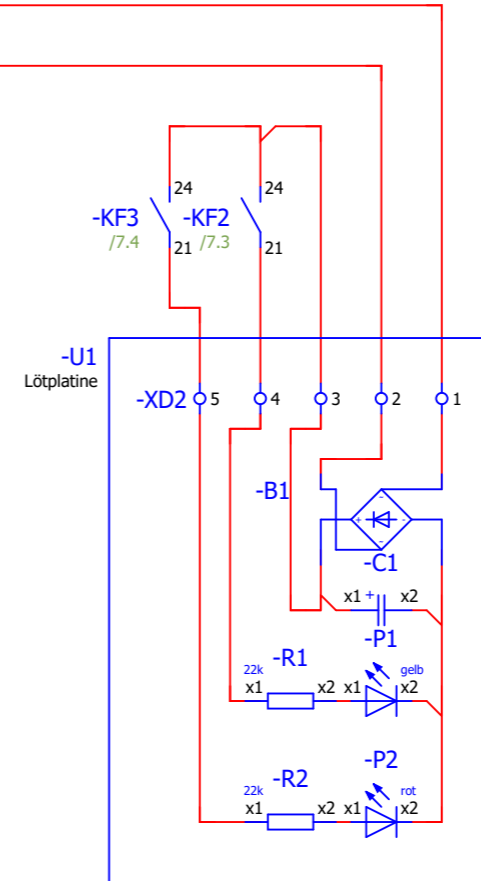

Bei Federzugklemmen dürfen keine Aderendhülsen verwendet werden!

Nicht verwendete Adern müssen einisoliert werden!

Torsteuerung

Stückliste

-XD2	Leiterplattenklemmleiste / Stecker, THT
-C1	Elektrolytkondensator 220µF / 63V
-R1	Schichtwiderstand 2,2kΩ / 1/4W
-R2	Schichtwiderstand 2,2kΩ / 1/4W
-P1	LED Gelb 2,5V / 20mA 5mm
-P2	LED Rot 2,5V / 20mA 5mm
-B1	Brückengleichrichter KBP

Bestückungsplan

